

# Polymer Roof Factory

PO Box 200, Vernon VT 05354

Phone 802-257-2011 • Fax 802-257-0846 • Toll Free 800-542-0203

[www.polymer-roof-factory.com](http://www.polymer-roof-factory.com)

Manufacture and sales of ABS roofs for doors, architectural building details and windows, including bow and bay windows



Our main products are: Garage door transoms and one piece ABS Polymer roofs for windows and doors. We use quality materials to construct and fabricate our products.

The company is located at 2533 Fort Bridgman Rd (Route 142) Vernon, Vermont in the southeast corner of the state. Customers in the area can visit our showroom.

Roofs are thermoformed with ABS polymers which have excellent color retention, impact resistance, strength, and longevity with an additional film to protect the products from the ultraviolet rays of the sun. Scrap plastic is recycled.

Customers can pick up products at our mill or products will be delivered by the best and most efficient way possible, our truck, common carrier, parcel/package services, or the US Post Office.

We provide quality products and good service at fair prices.



# Polymer Roof Factory

PO Box 200, Vernon VT 05354

Phone 802-257-2011 • Fax 802-257-0846 • Toll Free 800-542-0203

[www.polymer-roof-factory.com](http://www.polymer-roof-factory.com)

Manufacture and sales of ABS roofs for doors, architectural building details and windows, including bow and bay windows

**ABS Polymer Roofs** We manufacture one piece thermoformed roofs made from solid color ABS polymers that are UV stable for color retention and durability. These products are lightweight, strong, have room for insulation, can be used with cable system, have integral molded drip edge, nailing flange, no joints to leak, come with fasteners and are available in two colors, white and copper tone.

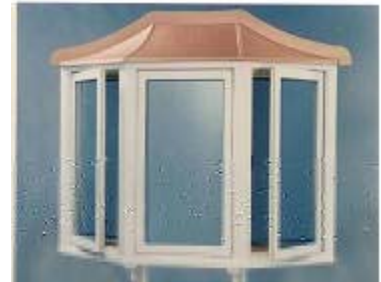

**C3Bow  
Coppertone**



**30°Bay  
White**



**Door and window Canopy Roof** Protect doors and windows and add an attractive accent to residential and commercial buildings with these one-piece molded ABS 80° canopy roofs.

**30MG White  
Canopy/Roof**



A note about ABS, ABS is amorphous terpolymer composed of acrylonitrile, butadiene, and styrene. These materials are extruded and thermoformed, typical applications include luggage, truck caps, spas, RV and automotive interior and exterior panels and trim, appliances, refrigerator liners, table tops, leisure crafts and of course our roofs and octagon one piece cladding.

# Polymer Roof Factory

PO Box 200, Vernon VT 05354  
Phone 802-257-2011 • Fax 802-257-0846 • Toll Free 800-542-0203  
[www.polymer-roof-factory.com](http://www.polymer-roof-factory.com)

Manufacture and sales of ABS roofs for doors, architectural building details and windows, including bow and bay windows

## What Are Bay and Bow Style Windows?

Bow and bay windows are valuable additions to many residential and commercial buildings. Here is a description of these windows.

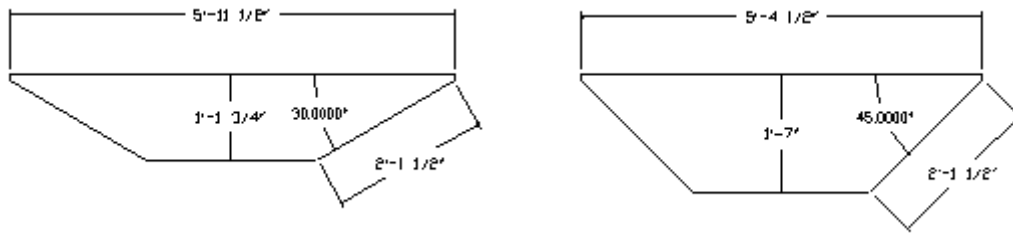

Bay windows provide an attractive accent, increased ventilation and view; do to the fact that the flankers project from the building and face left and right.

A bay window is actually a collection of at least three window units including a left and a right flanker usually arranged at either 30° or 45° angles and at least one unit as a center window. See the picture above that shows the same sized window units being used as either a 30° or 45° bay unit. The 45° projects farther from building but the 30° is a longer window.

The window units can be either double hung (sash slide up and down) or casements (sash crank out). The flanker units are usually one of the above and the center units are usually picture units. Jamb sizes of units are usually 4-9/16" (depth) to fit 2x4 framed walls and extensions are added for other wall thickness', for example 2x6 walls.

The designation of the assembly often consist of the angle and the name of the units, for example a double hung 45° 3442-18 would be 45° angle, 34 wide x 42 high center unit and 1'-8" (16" glass size) flankers, 42" high.

Casement bay units are named much the same way although some manufacturers may have their own numbers for the unit.

Bow windows are assembly's, like bays, but they are arranged at a much lesser angle, for example 10° or 12°, and bow windows therefore do not usually project as far from the building as bay windows. Each window assembly is usually made up of the same size casement units and all units open.

# Polymer Roof Factory

PO Box 200, Vernon VT 05354  
Phone 802-257-2011 • Fax 802-257-0846 • Toll Free 800-542-0203  
[www.polymer-roof-factory.com](http://www.polymer-roof-factory.com)

Manufacture and sales of ABS roofs for doors, architectural building details and windows, including bow and bay windows

## ABS Polymer Roofs for Casement Windows

Will fit these Andersen® windows

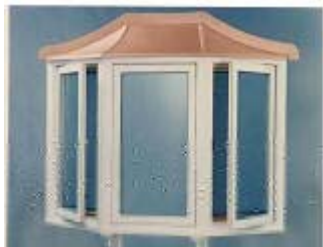

30° Roof shown on bay window



White ABS Bay Roof



Coppertone ABS Roof

See specification sheet for sizes of roofs to make sure that they will fit your application, for example, is their enough room between top of window and anything that may be above, like a soffit?



### 30-C-1 casement angle bay roof

fits these Andersen® units

30-C13-20  
30-C135-20  
30-C14-20  
30-C145-20  
30-C15-20  
30-C155-20  
30-C16-20

### 30-C-2 casement angle bay roof

fits these Andersen® units

30-C23-20 30-P4030-20  
30-C235-20 30- P4035-20  
30-C24-20 30- P4040-20  
30-C245-20 30- P4045-20  
30-C25-20 30- P4050-20  
30-C255-20 30- P4055-20  
30-C26-20 30- P4060-20

### C-3 Bow roof

Fits these Andersen® units

C-33 Bow  
C-335 Bow  
C-34 Bow  
C-345 Bow  
C-35 Bow  
C-355 Bow  
C-36 Bow

### 45-C-1 casement angle bay roof

fits these Andersen® units

45-C13-20  
45-C135-20  
45-C14-20  
45-C145-20  
45-C15-20  
45-C155-20  
45-C16-20

### 45-C-2 casement angle bay roof

fits these Andersen® units

45-C23-20 45- P4030-20  
45-C235-20 45- P4035-20  
45-C24-20 45- P4040-20  
45-C245-20 45- P4045-20  
45-C25-20 45- P4050-20  
45-C255-20 45- P4055-20  
45-C26-20 45- P4060-20

### °C-4 Bow roof

Fits these Andersen® units

C-43 Bow  
C-435 Bow  
C-44 Bow  
C-445 Bow  
C-45 Bow  
C-455 Bow  
C-46 Bow

Please see price page.

Please see sheet on freight charges or call for quote.

Prices subject to change without notice.

®Andersen registered trademarks of Andersen Corp, Bayport, Minnesota. The use of this name does not imply authorization or sponsorship by Andersen Corp.

Roofs listed here may available in White or Coppertone ABS.

Other sizes available.

A note about ABS, ABS is amorphous terpolymer composed of acrylonitrile, butadiene, and styrene. These materials are extruded and thermoformed. Typical applications include luggage, truck caps, spas, RV and automotive interior and exterior panels and trim, appliances, refrigerator liners, table tops, leisure crafts, our roofs and other products that we manufacture and sell. 26-Jul-05

# Polymer Roof Factory

PO Box 200, Vernon VT 05354  
Phone 802-257-2011 • Fax 802-257-0846 • Toll Free 800-542-0203  
[www.polymer-roof-factory.com](http://www.polymer-roof-factory.com)

Manufacture and sales of ABS roofs for doors, architectural building details and windows, including bow and bay windows

## Polymer Roofs for 30° Double Hung Windows

Will fit these Andersen® windows

The use of these roofs avoids custom roof construction or plywood kits, saves time and money and results in an attractive maintenance free roof.

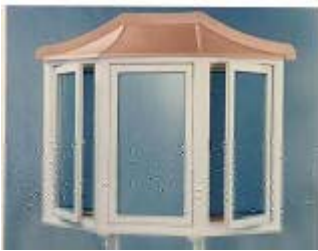

30° Roof shown on bay



White ABS Bay Roof

See specification sheet for sizes of roofs to make sure that they will fit your application, for example, is their enough room between top of window and anything that may be above, like a soffit?



### 30°-34-18 angle bay roof

fits these Andersen® double hung Narroline(200)® units

303442-18  
303446-18  
303456-18

### 30°-34-18 angle bay roof

fits these Andersen® double hung Tilt-Wash(400)® units

TW30-DHP3442-18  
TW30-DHP3446-18

### 30°-34-18 angle bay roof

fits these Andersen® double hung Tilt-Wash(400)® units

TW30-34310-18  
TW30-3442-18  
TW30-3446-18  
TW30-3452-18  
TW30-3456-18  
TW30-3462-18

Please see price page.

Please see sheet on freight charges or call for quote.

Call for technical and application information

Other sizes available.  
Prices subject to change without notice.

A note about ABS, ABS is amorphous terpolymer composed of acrylonitrile, butadiene, and styrene. These materials are extruded and thermoformed. Typical applications include luggage, truck caps, spas, RV and automotive interior and exterior panels and trim, appliances, refrigerator liners, table tops, leisure crafts, our roofs and other products

Roofs listed here may available in White or Coppertone ABS.

®Andersen registered trademarks of Andersen Corp, Bayport, Minnesota. The use of this name does not imply authorization or sponsorship by Andersen Corporation.

# Polymer Roof Factory

PO Box 200, Vernon VT 05354  
Phone 802-257-2011 • Fax 802-257-0846 • Toll Free 800-542-0203  
[www.polymer-roof-factory.com](http://www.polymer-roof-factory.com)

Manufacture and sales of ABS roofs for doors, architectural building details and windows, including bow and bay windows

## Polymer Roofs for 45° Double Hung Windows Will fit these Andersen® windows

The use of these roofs avoids custom roof construction or plywood kits, saves time and money and results in an attractive maintenance free roof.

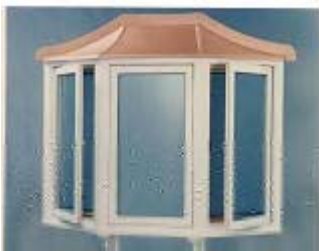

30° Roof shown on bay



White ABS Bay Roof

See specification sheet for sizes of roofs to make sure that they will fit your application, for example, is their enough room between top of window and anything that may be above, like a soffit?



45°-34-18 angle bay roof  
fits these Andersen® double hung  
Narroline(200)® units

453442-18  
453446-18  
453456-18

45°-34-18 angle bay roof  
fits these Andersen® double hung  
Tilt-Wash(400)® units

TW45-DHP3442-18  
TW45-DHP3446-18

45°-34-18 angle bay roof  
fits these Andersen® double hung  
Tilt-Wash(400)® units

TW45-34310-18  
TW45-3442-18  
TW45-3446-18  
TW45-3452-18  
TW45-3456-18  
TW45-3462-18

A note about ABS, ABS is amorphous terpolymer composed of acrylonitrile, butadiene, and styrene. These materials are extruded and thermoformed. Typical applications include luggage, truck caps, spas, RV and automotive interior and exterior panels and trim, appliances, refrigerator liners, table tops, leisure crafts, our roofs and other products that we manufacture and sell.

Roofs listed here may available in White or Coppertone ABS.

Other sizes available

Please see price page  
Please see sheet on freight charges  
or call for quote

®Andersen registered trademarks of Andersen Corp, Bayport, Minnesota. The use of this name does not imply authorization or sponsorship by Andersen Corporation

# Polymer Roof Factory

PO Box 200, Vernon VT 05354

Phone 802-257-2011 • Fax 802-257-0846 • Toll Free 800-542-0203

[www.polymer-roof-factory.com](http://www.polymer-roof-factory.com)

Manufacture and sales of ABS roofs for doors, architectural building details and windows, including bow and bay windows

## Polymer Roofs General Application Information

Save time and money when installing a roof on a Bay Window, Bow Window, or other construction projects. Avoid custom roof construction or plywood roof kits. The use of these roofs cut labor and material costs and results in an attractive maintenance free roof.

Applications can be determined by:

1. Polymer Roofs will fit some window manufacturers, a list of Polymer Roofs and the windows that they fit are attached see application information.
2. Polymer Roofs can be adapted to a bow or bay window using adapter or auxiliary casing fastened to top of window. See the Polymer Roofs instructions sheet and see the specifications sheets for sizes of the Polymer Roofs.
3. Many vinyl and wood bow or bay windows can be custom ordered to fit desired Polymer Roofs. see the specifications sheets for sizes of the Polymer Roofs.
4. Frame a bay window area into the wall construction using the Polymer Roofs sizes as a guide, stock window units can than be used to fill the framed openings. see the specifications sheets for sizes of the Polymer Roofs.
5. Canopy's can be installed over doors and windows as an attractive way to protect them from the elements, See Canopy roof specifications, Canopy installation instructions and Canopy soffit instructions.
6. Call us to discuss your project and we can help you get the correct product and size, some helpful information would be:
  - a. Roof manufacturer and model, if known.
  - b. Height over window (is there a soffit?).
  - c. Bow or bay, 30°, 45°, or what type of window or door?
  - d. Window jamb size of unit?
  - e. Masonry or wood construction?
  - f. Measurements of the window?
  - g. A good place to start would be to pick a pattern that looks close to the shape of the top of your window. Go to the specification sheet and select set of specifications that seem close or a little larger than your window and than make a cardboard pattern using those dimensions. Try this pattern on your window and see how it fits, a little larger can sometimes be okay because it leaves more room for trim etc.

# Polymer Roof Factory

PO Box 200, Vernon VT 05354

Phone 802-257-2011 • Fax 802-257-0846 • Toll Free 800-542-0203

[www.polymer-roof-factory.com](http://www.polymer-roof-factory.com)

Manufacture and sales of ABS roofs for doors, architectural building details and windows, including bow and bay windows

## Bay Roof Installation Instructions

Polymer roofs are designed to be installed with auxiliary casing provided by window manufacturer or others. See illustration below. This casing is sometimes no more than a piece of 1"x1" pine to fill in the space between the platform or head board and the outer edge of the window and is used to provide fastening for the roof. Sometimes this piece could be a little wider to better fill in the space between the window and the roof or perhaps higher and wider to provide space for a crown molding.

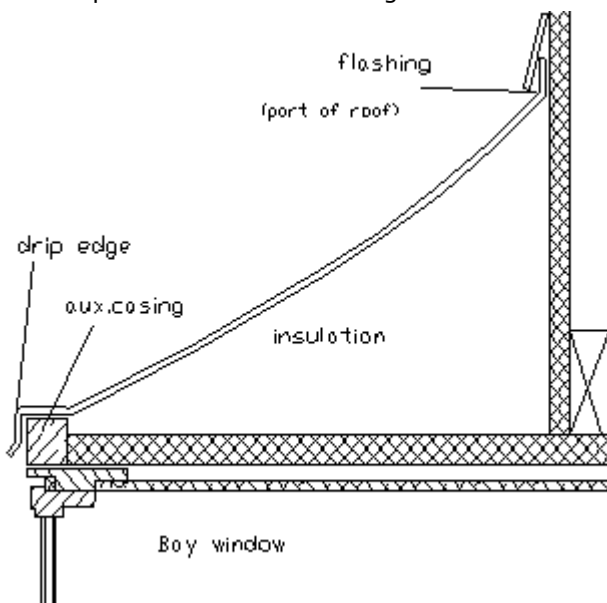

1. Install Auxiliary Casing.
2. Caulk surface of flashing and other surfaces of roof where it meets building and window.
3. Attach roof to auxiliary casing with the screws provided.
4. After the roof has been attached to the window use galvanized or stainless steel roofing nails to attach the roof flashing to the building. Use the nail holes provided or drill at least 3/16" holes. Do not nail tight: leave room for expansion.
5. Install the siding: do not nail through the flashing flange.
6. No other finishing is recommended and may void warranty.
7. Care must be taken to insure that windows are installed in accordance with manufacturers instructions including support by cables or knee brackets to keep windows from sagging.



# Polymer Roof Factory

PO Box 200, Vernon VT 05354

Phone 802-257-2011 • Fax 802-257-0846 • Toll Free 800-542-0203

[www.polymer-roof-factory.com](http://www.polymer-roof-factory.com)

Manufacture and sales of ABS roofs for doors, architectural building details and windows, including bow and bay windows

## C3B and C4B Bow Roof Installation Instructions

Polymer roofs are designed to be installed with auxiliary casing provided by window manufacturer or others. See illustration below. This casing is sometimes no more than a piece of 1"x1" pine to fill in the space between the platform or head board and the outer edge of the window and is used to provide fastening for the roof. Sometimes this piece could be a little wider to better fill in the space between the window and the roof or perhaps higher and wider to provide space for a crown molding.

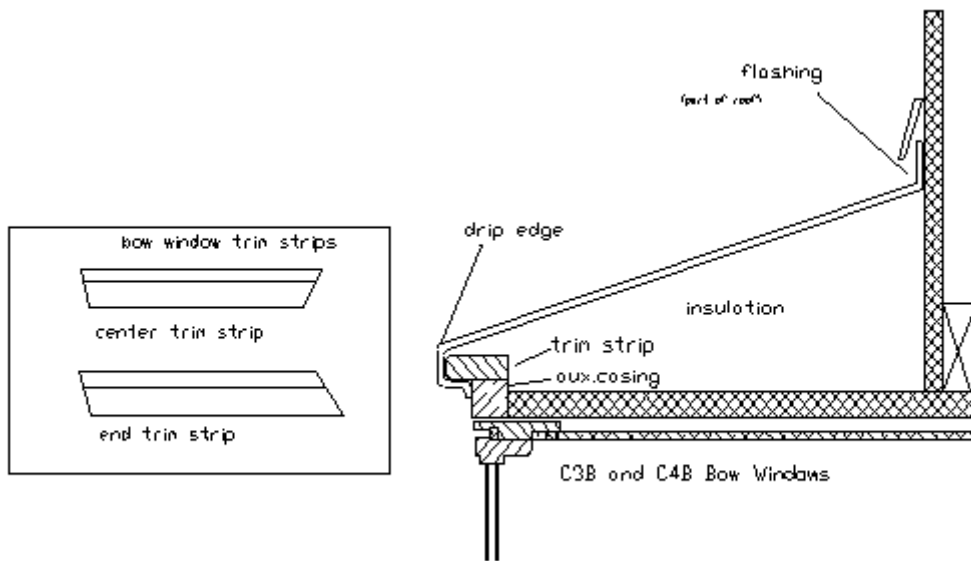

1. Install Auxiliary casing: install trim strip.
2. Caulk surface of flashing and other surfaces of roof where it meets building and window.
3. These bow window roofs are attached in front by fitting over trim strip.
4. After the roof has been attached to the window use galvanized or stainless steel roofing nails to attach the roof flashing to the building. Use the nail holes provided or drill at least 3/16" holes. Do not nail tight: leave room for expansion.
5. Install the siding: do not nail through the flashing flange.
6. No other finishing is recommended and may void warranty.
7. Care must be taken to insure that windows are installed in accordance with manufacturers instructions including support by cables or knee brackets to keep windows from sagging.

# Polymer Roof Factory

PO Box 200, Vernon VT 05354

Phone 802-257-2011 • Fax 802-257-0846 • Toll Free 800-542-0203

[www.polymer-roof-factory.com](http://www.polymer-roof-factory.com)

Manufacture and sales of ABS roofs for doors, architectural building details and windows, including bow and bay windows

## K Bow Roof Installation Instructions

Polymer roofs are designed to be installed with auxiliary casing provided by window manufacturer or others. See illustration below. This casing is sometimes no more than a piece of 1"x1" pine to fill in the space between the platform or head board and the outer edge of the window and is used to provide fastening for the roof. Sometimes this piece could be a little wider to better fill in the space between the window and the roof or perhaps higher and wider to provide space for a crown molding.

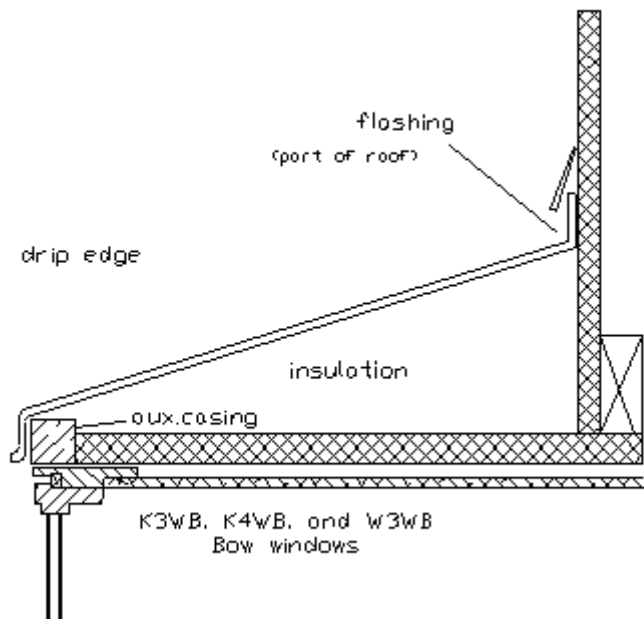

1. Install Auxiliary casing: install trim strip.
2. Caulk surface of flashing and other surfaces of roof where it meets building and window.
3. These bow window roofs are attached in front by caulking to auxiliary casing.
4. After the roof has been set on the window use galvanized or stainless steel roofing nails to attach the roof flashing to the building. Use the nail holes provided or drill at least 3/16" holes. Do not nail tight: leave room for expansion.
5. Install the siding: do not nail through the flashing flange.
6. No other finishing is recommended and may void warranty.
7. Care must be taken to insure that windows are installed in accordance with manufacturers instructions including support by cables or knee brackets to keep windows from sagging.

# Polymer Roof Factory

PO Box 200, Vernon VT 05354  
 Phone 802-257-2011 • Fax 802-257-0846 • Toll Free 800-542-0203  
[www.polymer-roof-factory.com](http://www.polymer-roof-factory.com)

Manufacture and sales of ABS roofs for doors, architectural building details and windows, including bow and bay windows

## Stock Bow and Bay Window Specifications

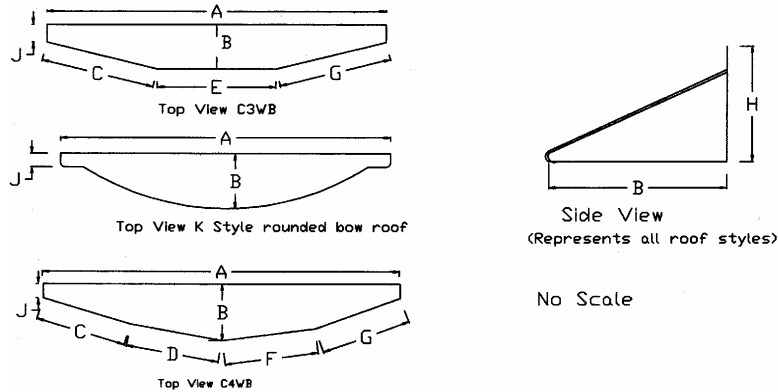

Unit number	Lgth(A)	Proj(B)	(C)	(D)	(E)	(F)	(G)	Hgt(H)	Jut (J)	
C3Bow	74-1/2"	5-1/4"	24-1/2"		25-1/2"		24-1/2"	7-1/2"	1"	
C4Bow	98"	10-1/2"	24-3/4"	24-3/4"		24-3/4"	24-3/4"	6-3/4"	1-1/2"	
W3WB	71"	7-1/2"	Semi-arc					5"		
K3WB	72-1/2"	4-1/2"	Semi-arc projection, K style (see above)						5-1/2"	
K4WB	94-1/2"	7-7/8"	Semi-arc projection, K style (see above)						5-1/2"	

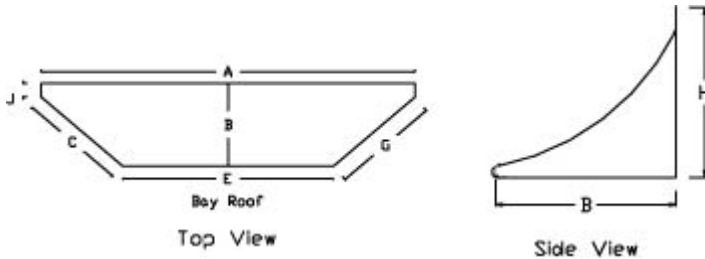

Measurements are taken from the inside of the roof so that this is the outside dimension of the window or unit over which the roof will fit. The exception is the height (H) which is from the bottom of the drip edge to the top of the nailing flange (approximate sizes in inches).

Unit number	Length(A)	Projection(B)	Flank(C)	Center(E)	Flank(G)	Jut(J)	Height(H)
30°C 1	71-1/2	13-1/2	25-1/2	26-1/2	25-1/2	1	13-1/2
30°C 2	94	13-7/8	25	49-3/4	25	1	14
45°C1	64-1/2	19	25 1/2	27-1/2	25-1/2	1	20
45°C2	88	19-1/2	25-1/2	51-1/2	25-1/2	1	20
A30°3418	85-1/2	13	23	44-1/2	23	1-3/4	13
A45°3418	81-1/2	18	24	46	24	1	19
K30°1820	68	13	23	27-1/2	23	1	12
K30°1828	77-3/4	14	24	35-1/2	24	1-3/4	13
K30°1834	85	14	23-3/4	44	23-3/4	1-3/4	14
K30°1850	105	14	24	63-1/2	24	1-3/4	14
K30° NP 40	94	13-1/4	24	51-1/2	24	1	13

# Polymer Roof Factory

PO Box 200, Vernon VT 05354  
 Phone 802-257-2011 • Fax 802-257-0846 • Toll Free 800-542-0203  
[www.polymer-roof-factory.com](http://www.polymer-roof-factory.com)

Manufacture and sales of ABS roofs for doors, architectural building details and windows, including bow and bay windows

## Door and Window Awning/Canopy Roof Specifications

Protect entry doors, patio doors and windows and add an attractive detail to residential and commercial buildings with these one-piece molded ABS roofs.

These one-piece thermoformed roofs are made from solid color ABS polymers and are ultra violet stable for color retention and durability and offer an excellent alternative to canvas and aluminum awnings.

These roofs are, lightweight, strong, can be used with cable system, have integral molded drip edge, nailing flange, no joints to leak, come with fasteners, instructions, and soffit plans. Available in two colors white and copper tone.

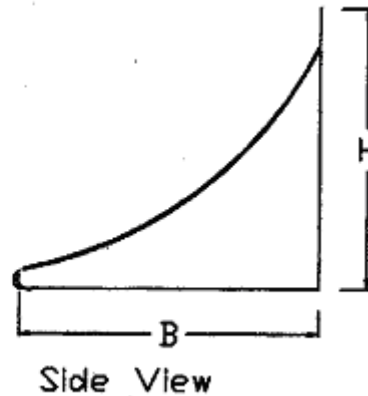
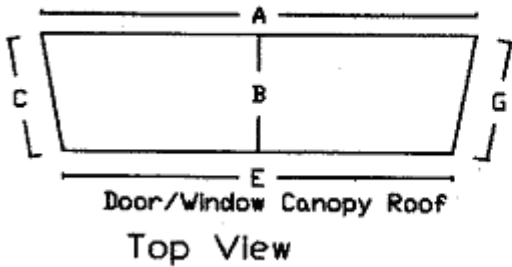

Measurements are taken from the inside of the roof so that this is the outside dimension of the window or unit over which the roof will fit. The exception is the height (H) which is from the bottom of the drip edge to the top of the nailing flange. Approximate sizes in inches)

Canopies are quickly installed with a simple assembled plywood soffit system. System can be purchased with the canopy or you can easily make your own with the aid of precise plans supplied with the instructions.

Unit number	Length(A)	Projection(B)	Flank(C)	Center(E)	Flank(G)	Height(H)
30MG 80°	44-3/4"	15-1/2"	15-3/4"	39"	15-3/4"	16"
40MG 80°	56-3/4"	15-1/2"	15-3/4"	50-7/8"	15-3/4"	16"
60MG 80°	80-3/8"	15-1/2"	15-3/4"	74-1/2"	15-3/4"	16'

# Polymer Roof Factory

PO Box 200, Vernon VT 05354  
 Phone 802-257-2011 • Fax 802-257-0846 • Toll Free 800-542-0203  
[www.polymer-roof-factory.com](http://www.polymer-roof-factory.com)

Manufacture and sales of ABS roofs for doors, architectural building details and windows, including bow and bay windows

## Plywood Soffit Kit



40 MG Shown

First Line Sales  
 PDB 200 Vernon Vt 05354  
 802 257 2011

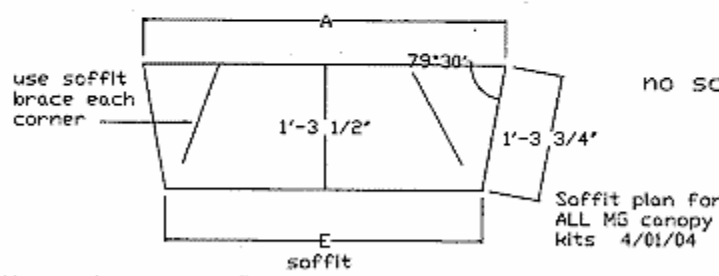
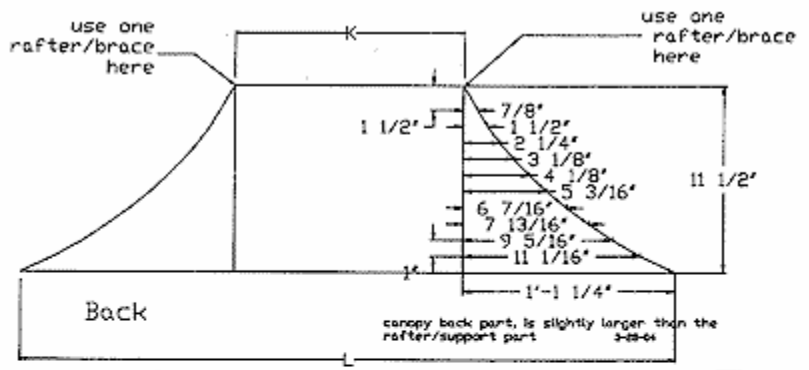
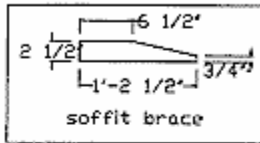

unit	A	E	K	L
30MG	44-3/4"	39"	14-1/4"	40-3/4"
40MG	56-3/4"	50-7/8"	26-5/8"	53-1/8"
60MG	80-3/8"	74-1/2"	40-1/2"	77"

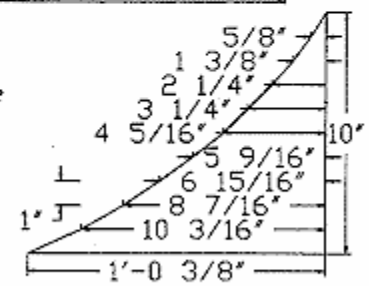

rafter/brace support plan for use with 30MG, 40MG and 60MG  
 3-28-04

# Polymer Roof Factory

PO Box 200, Vernon VT 05354  
Phone 802-257-2011 • Fax 802-257-0846 • Toll Free 800-542-0203  
[www.polymer-roof-factory.com](http://www.polymer-roof-factory.com)

Manufacture and sales of ABS roofs for doors, architectural building details and windows, including bow and bay windows

## Canopy Installation Instructions

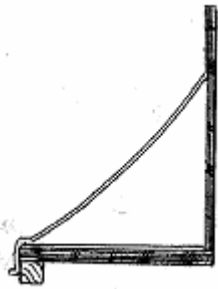

All polymer canopy roofs are designed to be installed supported over a Bay or Garden window (see window instructions) or installed freestanding, as over a door, with a supporting soffit system. This system can be purchased as an accessory or be built on site using plans provided.

All polymer canopies are designed to be installed with auxiliary trim casing provided by others. This trim casing is fastened to the bottom of the soffit system as shown here. Or the top of a window (not shown) The size of this piece is 1" x 2" but could be any size 1" x \_ as per installers design, it could cover the entire soffit if desired.

1. Install trim casing as shown above.
2. Caulk surface of flashing and other nailing surfaces of roof where it meets soffit and building.
3. Attached the canopy to the trim casing with screws supplied with roof.
4. Attach the canopy to the building with galvanized nails using the holes provided in the flashing or pre-drill a hole larger than the shank of the nail, leave room for expansion. Do not nail tight.
5. Install siding, do not nail through the flashing.
6. No other finishing of canopy is necessary and may void warranty.
7. Care must be taken to insure that canopy soffits are installed securely so that they do not sag etc. The canopy roof is designed to provide style and weatherability. They are strong but are not designed to support themselves or the building components they protect.

# Polymer Roof Factory

PO Box 200, Vernon VT 05354

Phone 802-257-2011 • Fax 802-257-0846 • Toll Free 800-542-0203

[www.polymer-roof-factory.com](http://www.polymer-roof-factory.com)

Manufacture and sales of ABS roofs for doors, architectural building details and windows, including bow and bay windows

## Canopy Installation Instructions

This part allows the canopy to be installed without under bracing or brackets. The assembled part is fastened to the building to create a firm base for the canopy. It is suggested that all parts be glued and screwed together. Each unit is made up of 4 different parts: 1-each of part A "Soffit", 1-each of part B "Back", 2-each of part C "Soffit Brace", and part D "Rafter/Brace" (see figure 2 below for quantity for part D Rafter/Brace).

1. The Back is centered on the long edge of the Soffit and fastened to the Soffit.
2. The Rafter/Brace parts are installed fastened to the back and the Soffit. 2 parts for the 30MG, 3 for the 40MG and 4 for the 60MG. Put one rafter/brace on each end and put additional braces for 40MG and 60MG in the center.
3. The Soffit braces are installed from the inside corner of the Rafter/Brace at an angle toward the outside corner of the Soffit one on each corner. This part is used to stiffen the Soffit at this point.
4. See soffit plans for detailed drawings of parts

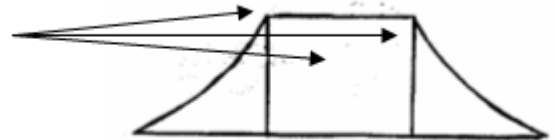

Figure 1

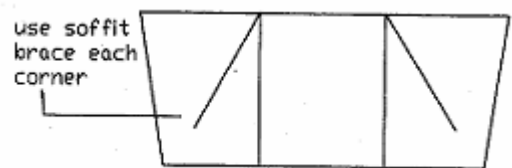

Figure 2



Plywood Soffit Canopy Support



White ABS Canopy

# Polymer Roof Factory

PO Box 200, Vernon VT 05354  
Phone 802-257-2011 • Fax 802-257-0846 • Toll Free 800-542-0203  
[www.polymer-roof-factory.com](http://www.polymer-roof-factory.com)

Manufacture and sales of ABS roofs for doors, architectural building details  
and windows, including bow and bay windows

## Pricing Information: ABS Roofs, White & Coppertone

Save time and money when installing a roof on a Bay Window, Bow Window, or other construction projects. Avoid custom roof construction or plywood roof kits. The use of these roofs cut labor and material costs and results in an attractive maintenance free roof.

These one piece thermoformed roofs are made from solid ABS polymers.

Unit, price each	White	Copper
30C1	\$115.94	\$120.79
30C2	\$137.42	\$143.21
45C1	\$133.49	\$139.34
45C2	\$157.89	\$165.36
C3Bow	\$93.35	\$96.73
C4Bow	\$116.81	\$121.09
A303418	*	\$137.16
A453418	*	\$165.39
K301820	*	\$115.94
K301828	*	\$129.70
K301834	*	\$137.16
NWMini bay	*	\$129.70
K3WBow	\$38.29	*
K4WBow	\$61.09	*
W3WB	\$38.29	*
W30 BAY	\$95.84	\$98.74
30MG	\$99.59	\$106.46
40MG	\$117.98	\$122.86
60MG	\$142.58	\$149.05

\*call for availability

Price does not include freight. Please see sheet on shipping charges or call for information.  
Prices subject to change without notice  
05/01/2006





# Polymer Roof Factory

PO Box 200, Vernon VT 05354  
 Phone 802-257-2011 • Fax 802-257-0846 • Toll Free 800-542-0203  
[www.polymer-roof-factory.com](http://www.polymer-roof-factory.com)

Manufacture and sales of ABS roofs for doors, architectural building details and windows, including bow and bay windows

## Roof Shipping Charges

Charges are estimated to contiguous 48 states. Shipping charges are based on the size and weight of the item and destination. Multiple roofs to the same address may be able to be grouped for savings on shipping charges. Other charges may apply.

Destination shipping charges are determined by the first number of the zip code in which the roof is to be shipped, for example 05354 would be priced under the "0" column.

Please call if you need assistance with shipping rates, including rates to other destinations.

Charges for Cont. USA	Zip code begins with, 0	Zip code begins with, 1,2	Zip code begins with, 3,4,5,6,7,	Zip code begins with, 8,9
Unit	os	Shipping charge	Shipping charge	Shipping charge
30C1	3	\$55	\$56	\$59
30C2	3	\$55	\$56	\$59
45C13	3	\$55	\$56	\$59
45C2		Call for cost		
C3Bow	2	\$23	\$26	\$35
C4Bow	3	\$55	\$56	\$59
A303418	3	\$55	\$56	\$59
A453418	3	\$55	\$56	\$57
NWMinibay	3	\$55	\$56	\$59
K301820	2	\$23	\$26	\$35
K301828	3	\$55	\$56	\$59
K301834	3	\$55	\$56	\$59
K3Wbow	1	\$17	\$18	\$23
K4Wbow	2	\$23	\$26	\$35
W3WB	1	\$17	\$18	\$23
W30BAY	3	\$55	\$56	\$59
30MG	2	\$23	\$26	\$35
40MG	2	\$28	\$31	\$40
60MG	3	\$55	\$56	\$59

Prices subject to change without notice.